



2000 S DAHLIA ST

Denver, CO 80222

FLEX SPACE | 100% LEASED

Desirable location
near Colorado Blvd, dining,
shopping & more!

Local ownership
& property management
less than 1 mi away

Convenient access
to I-25 & Evans Ave

PROPERTY HIGHLIGHTS



BUILDING SIZE
19,941 SF



DOORS
~14' x 12' DRIVE-IN



ZONING
I-MX-3



CLEAR HEIGHTS
~15'



TRAFFIC COUNTS
S DAHLIA ST @
E EVANS AVE
50,584 VPD
(2022, MPSI)



1805 S. Bellaire St., #400
Denver, CO 80222
303-333-7500
www.matrixgroupinc.com

LAUREN QUIRAM
DIRECTOR OF LEASING
lquiram@matrixgroupinc.com
303-300-5271

2000 S DAHLIA ST



100% LEASED

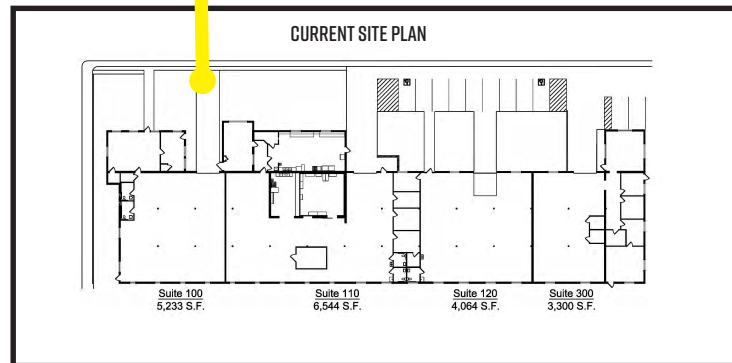

LAUREN QUIRAM
DIRECTOR OF LEASING
lquiram@matrixgroupinc.com

303-300-5271

1805 S. Bellaire St., #400
Denver, CO 80222
303-333-7500
www.matrixgroupinc.com

